

TYPE SW2

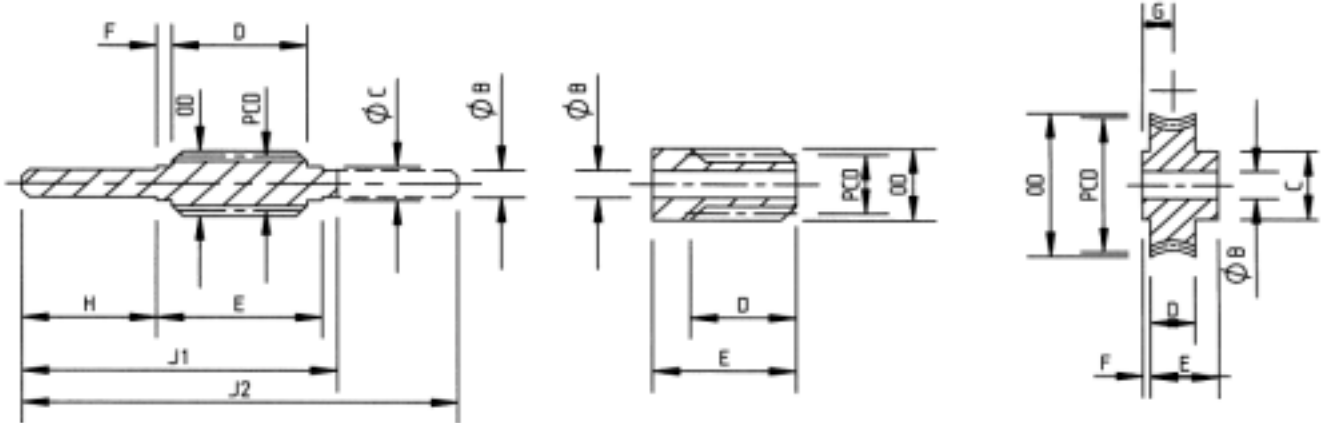

Type SW2 Worms and Wormwheels

Dimensions in inches

	B	Bore B	C	D	E	F	G	H	J1	J2
Worm	0.187	0.125	0.255	0.625	1.000	0.187		1.250	2.406	3.500
Wheel	0.250		0.500	0.281	0.485	0.015	0.156			

O.D and P.C.D Dimensions

Ratio	Worm		Wheel	
	P.C.D	O.D	P.C.D	O.D
7.5-- 1	0.307	0.375	1.193	1.300
8-- 1	0.341	0.408	1.159	1.250
10-- 1	0.383	0.454	1.116	1.200
12-- 1	0.325	0.388	1.175	1.250
15-- 1	0.307	0.384	1.193	1.300
16-- 1	0.330	0.401	1.170	1.275
16.6-- 1	0.340	0.385	1.160	1.225
17-- 1	0.300	0.369	1.200	1.300
20-- 1	0.377	0.433	1.123	1.200
21.5--1	0.322	0.376	1.178	1.250
24-- 1	0.281	0.331	1.219	1.300
25--1	0.364	0.407	1.136	1.200
30-- 1	0.307	0.368	1.193	1.300
32--1	0.306	0.38	1.194	1.300
36-- 1	0.292	0.346	1.208	1.300
40-- 1	0.386	0.442	1.114	1.200
42-- 1	0.329	0.384	1.171	1.250
45-- 1	0.278	0.322	1.222	1.300
48-- 1	0.296	0.346	1.204	1.275
50-- 1	0.364	0.409	1.136	1.200
60-- 1	0.298	0.338	1.203	1.250
90-- 1	0.248	0.276	1.225	1.330
100-- 1	0.227	0.252	1.273	1.33

Material

Worm :- Steel, with hardened and polished thread.

Wormwheel :- Phosphor Bronze BS 1400 PB 1.

When ordering please specify, Single, Double ended or Bored Worm. Anti Backlash Wormwheels also available.